

FJORD

NWT90

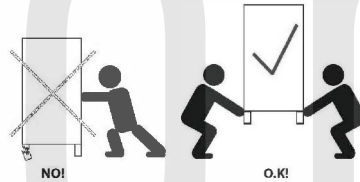
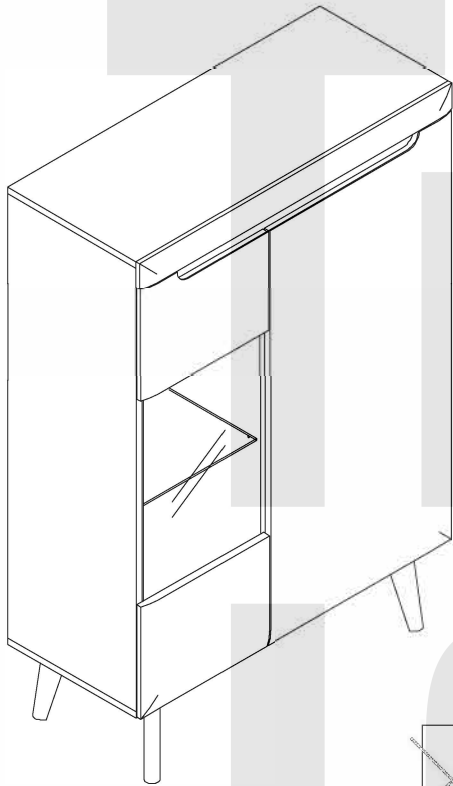

31.8.2017

- D** Montageanleitung
- FR** Notice de montage
- NL** Handleiding voor de montage
- CZ** Montážní návod
- HU** Szerelési útmutató
- TR** Montaj talimatı

- GB** Assembly Instructions
- IT** Istruzioni di montaggio
- PL** Instrukcja montaży
- SK** Návod na montáž
- RO** Instrucțiuni de montaj
- RU** Инструкции по монтажу

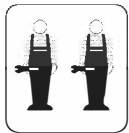

20 min.

1

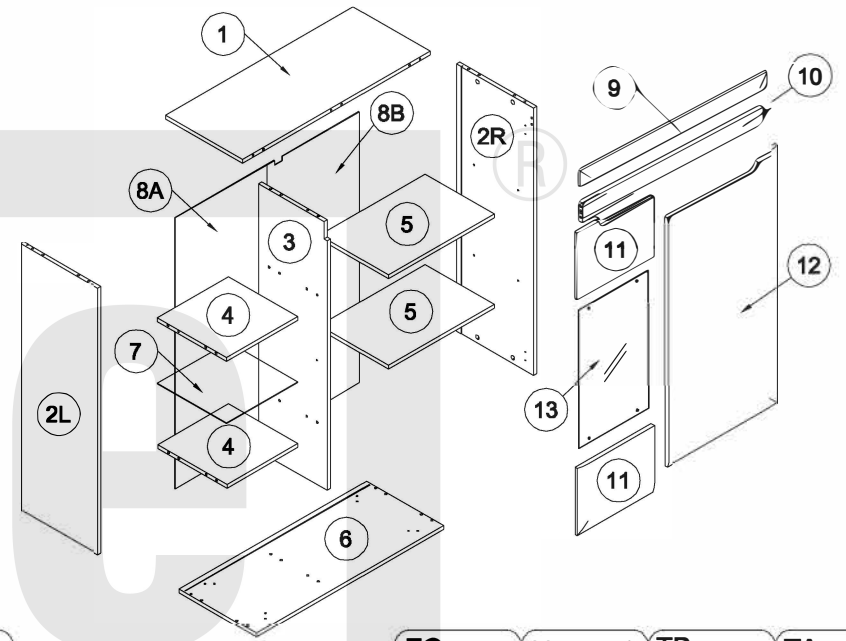

ZA x1	ZC x8	NA 4x13 x1	TB x1	TA x1
C x23	Z x23	HD x8	NGD x4	N 3x20 x14
X x14	ZE x4	Z x8	B x23	A 8x32 x27
H 6,3x13 x10	R x5	PC x5	NC 4x16 x4	ND 3,5x16 x10
ZD x4				

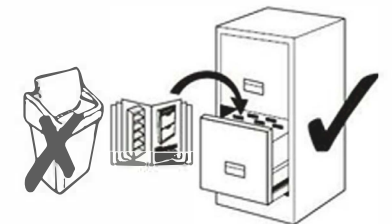
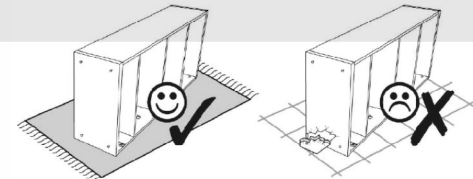

2

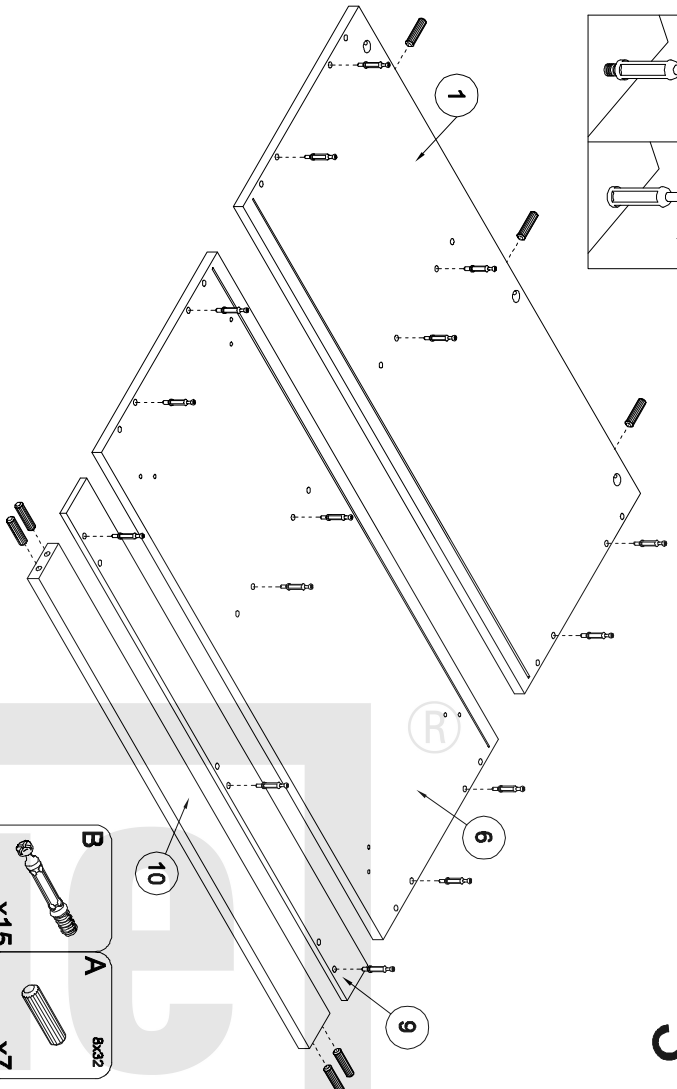
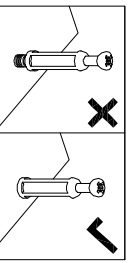

3

- | | |
|----------|----------|
| B | A |
| | |
| X15 | 8x32 |
| X7 | |

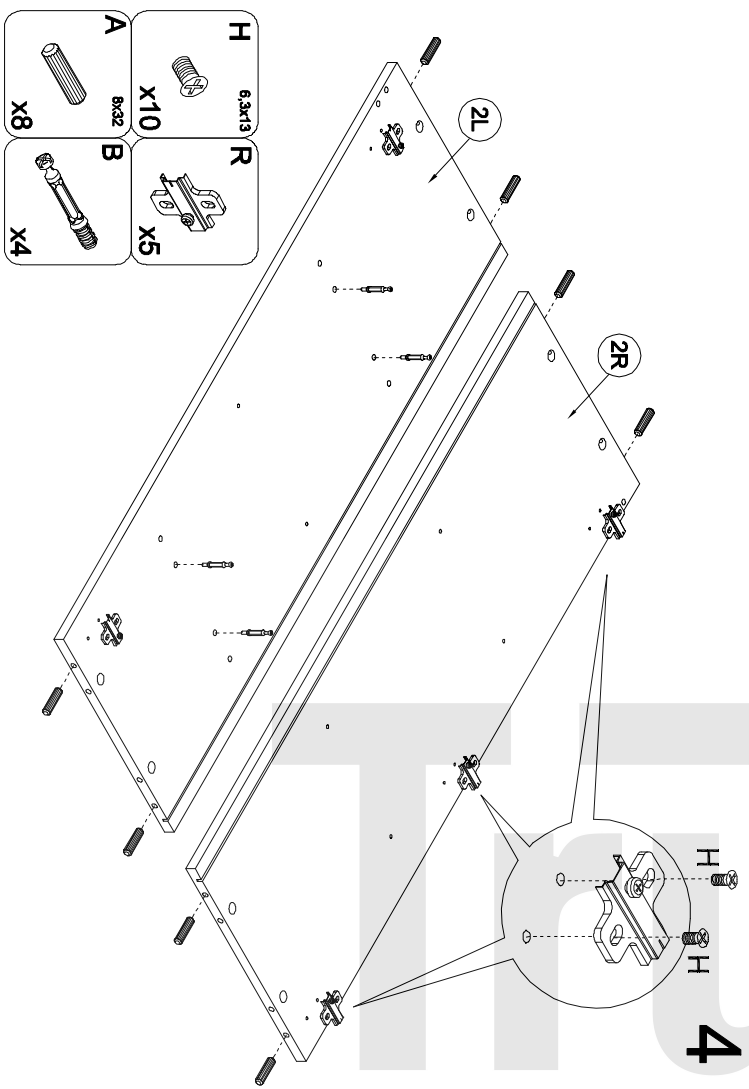

4

- | | |
|----------|----------|
| H | R |
| | |
| 6.3x13 | X5 |
| X10 | |
| 8x32 | |
| A | B |
| | |
| X8 | X4 |

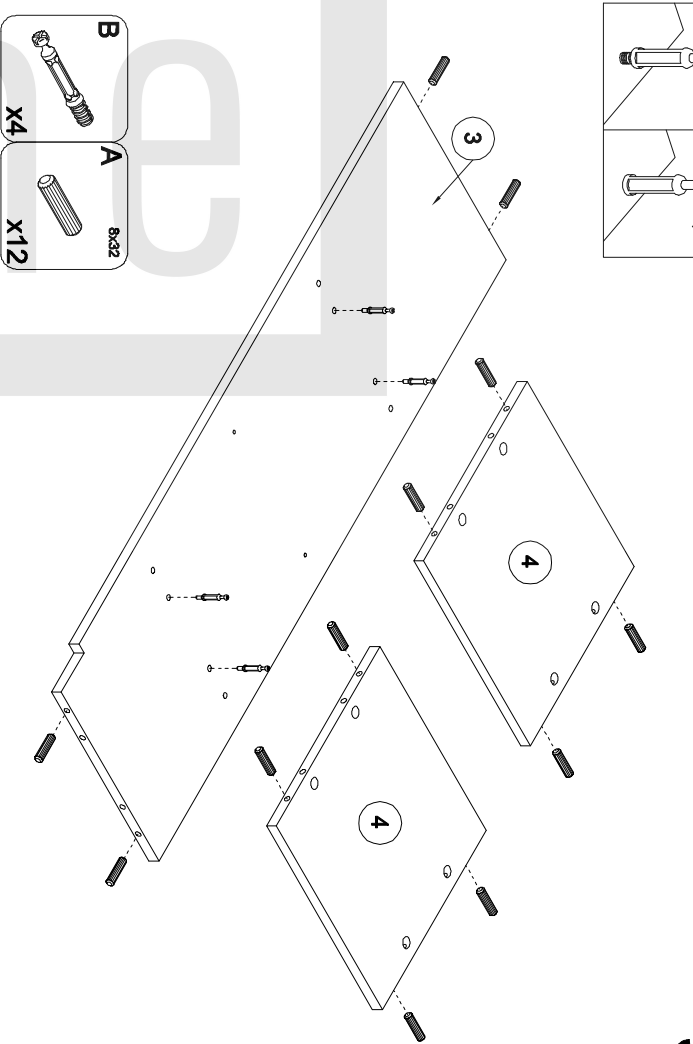
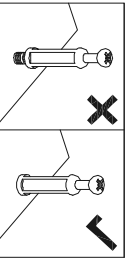

5

- | | |
|----------|----------|
| B | A |
| | |
| X4 | 8x32 |
| X12 | |

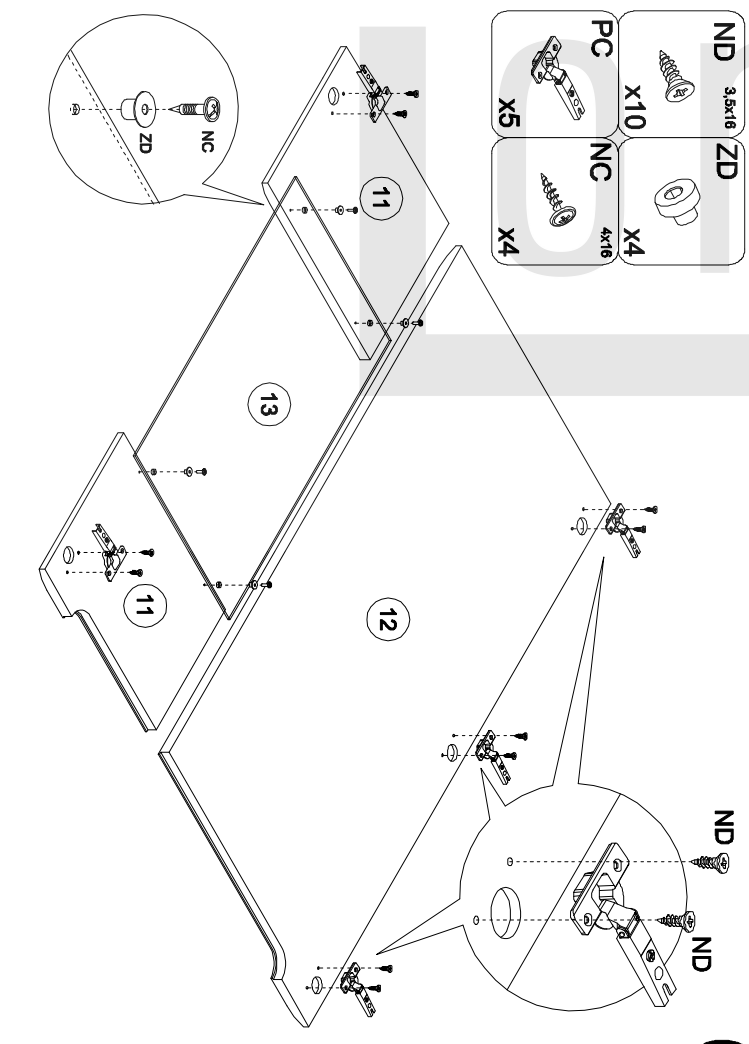

6

- | | |
|-----------|-----------|
| ND | ZD |
| | |
| 3.5x16 | X4 |
| X10 | 4x16 |
| PC | NC |
| | |
| X5 | X4 |

- | | |
|-----------|-----------|
| NC | ZD |
| | |
| X4 | X4 |

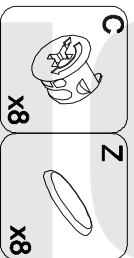
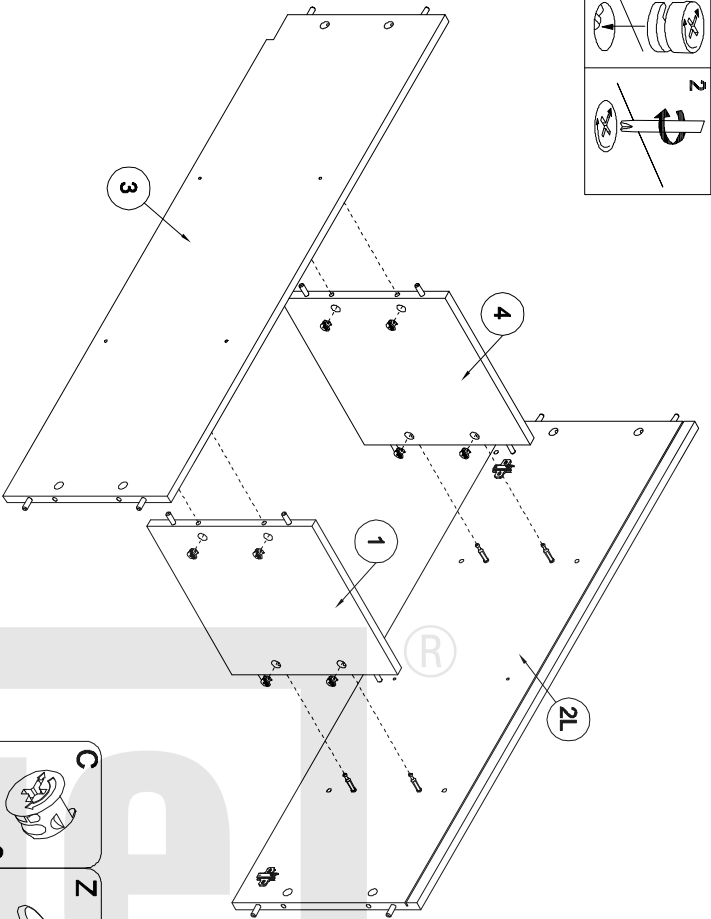
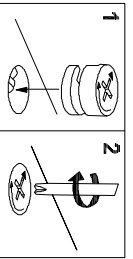

7

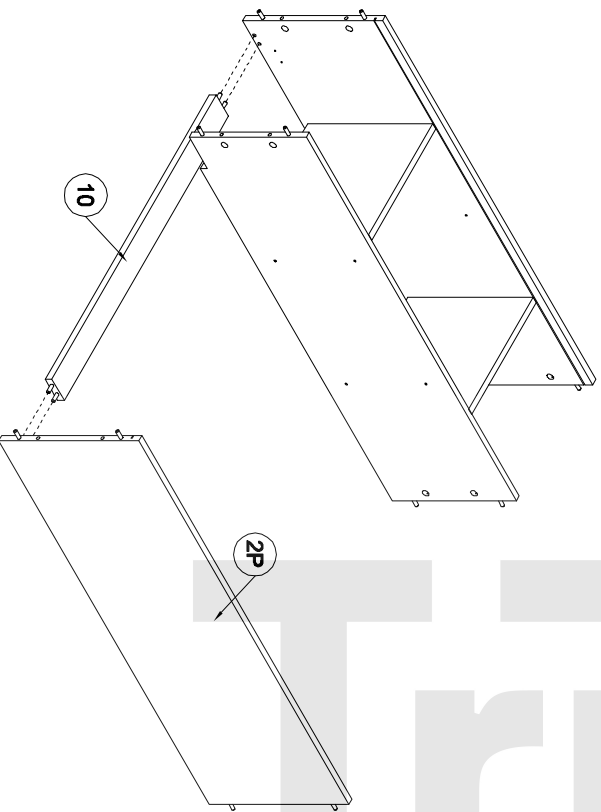

8

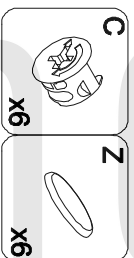
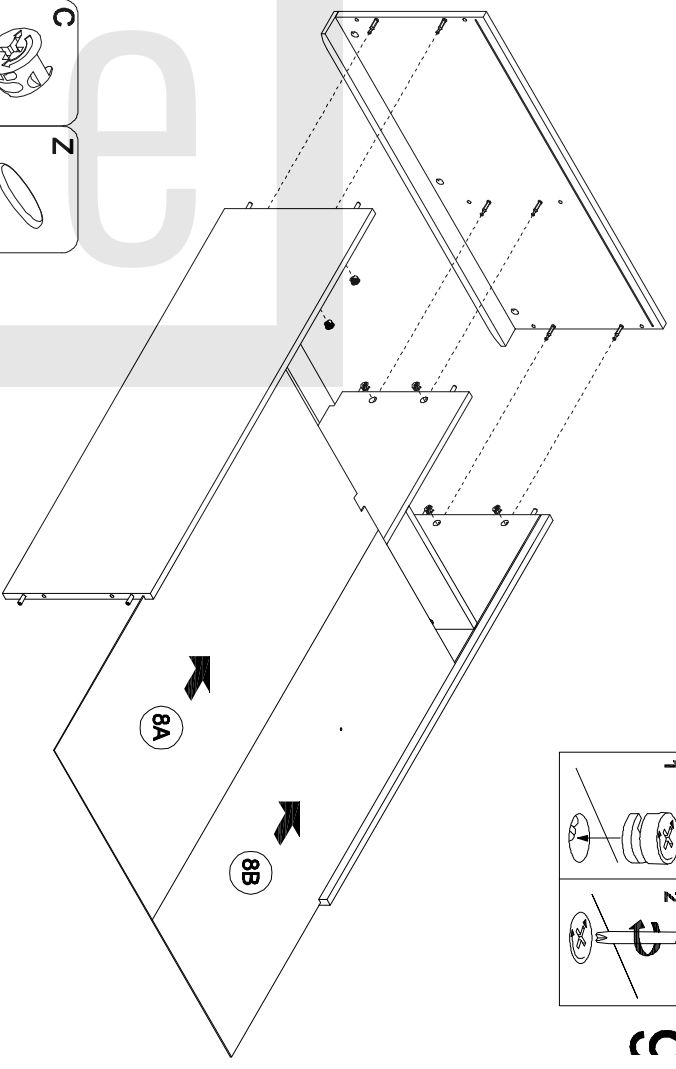
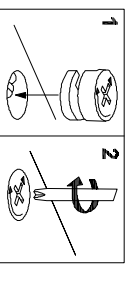

9

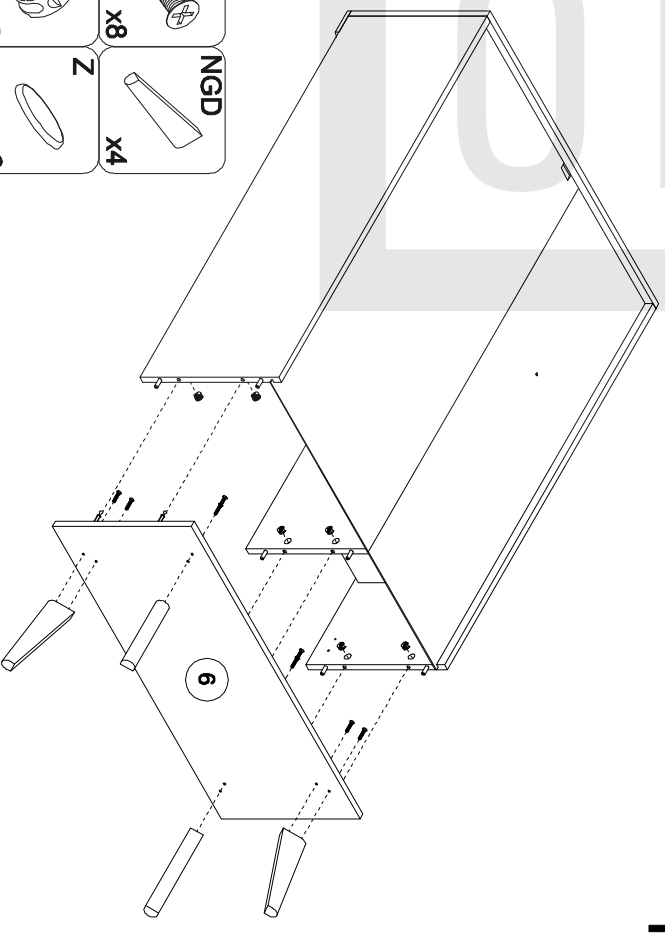
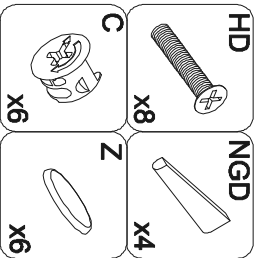

10

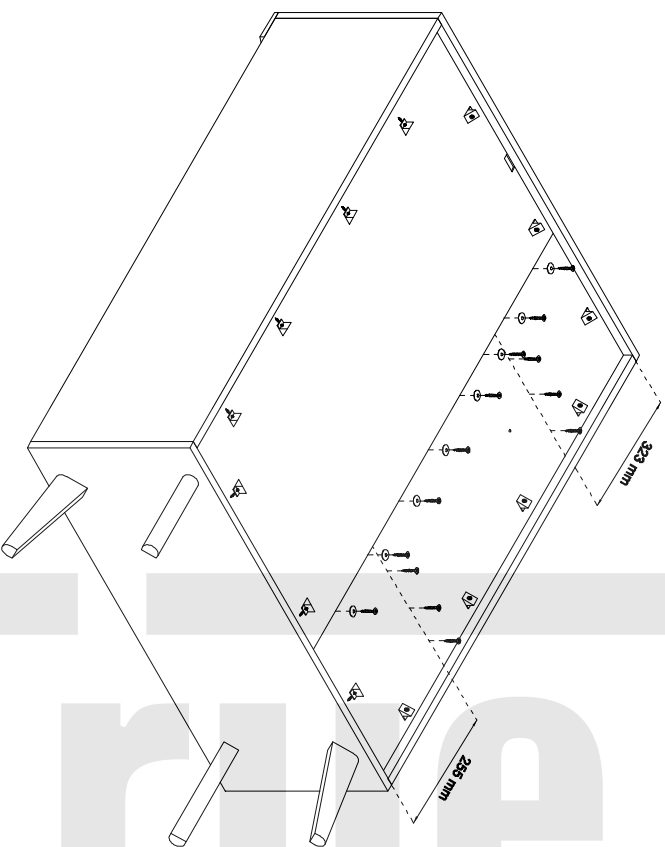
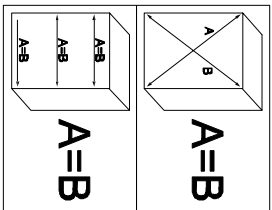

®

11

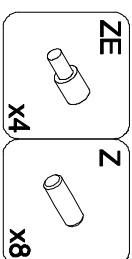
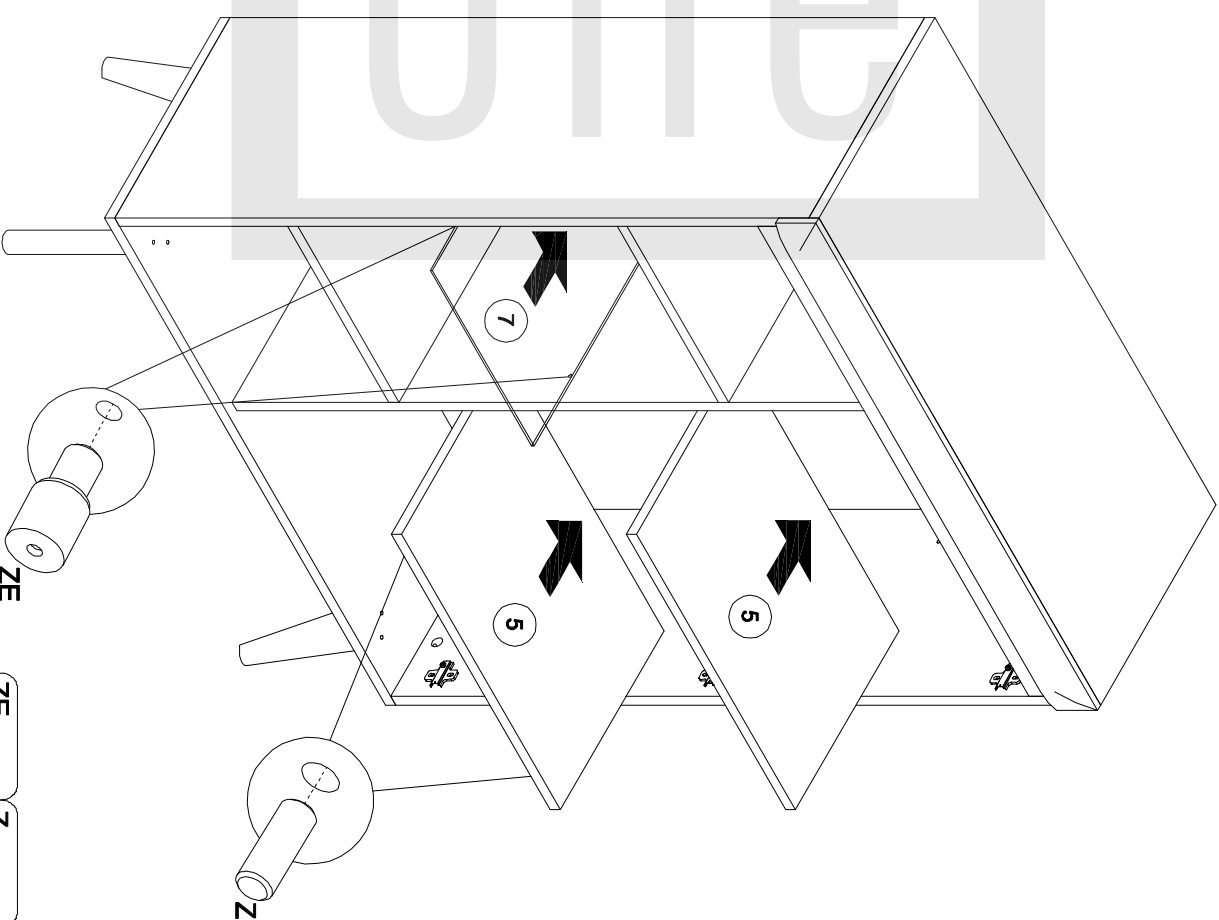
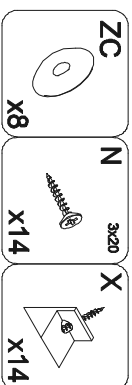

12

- NA 4x13
x1
- TB
x1
- TA
x1
- ZA
x1

